

Procedures for adding CD images to your Pre-Paid CD



Frawgbyte Photography
PO Box 271
Highland, MI 48357
248-821-7239

www.frawgbyte.com / photos@frawgbyte.com

contact: Yvette Abbott



<http://www.facebook.com/FrawgbytePhotography>

Click here for link to MIHA STATE MEET 2011



2011-2012

Purchase Photos // Select your gallery to purchase photos



Congratulations to the HARTLAND High School Equestrian Team on their 2011 STATE TITLE and the OXFORD High School Equestrian Team on their RESERVE STATE TITLE!



Stay Connected



Keep track of Frawgbyte Photography on all your favorite social networks.

Contact Information

(248) 821-7239
photos@frawgbyte.com
www.frawgbyte.com



MIHA State Meet 2011

Home > MIHA > MIHA State Meet 2011

Gallery expires on December 31, 2011

Invite family & friends

Navigate galleries



NOTE CHANGE: If you have purchased a prepaid CD select the appropriate image CD option. Use your coupon code that was emailed to you (let us know if you have not received your code)when you check out. [the coupon option will be on your shopping cart page]Please select "Pre-Paid" options for shipping and payment. For those who purchased only 10 images and want to upgrade to 25 at the show special please send us an email at photos@frawgbyte.com. Thanks and congratulations to each of you! -Sincerely, Yvette and Diana



MIHA State Finals 2011

**2. sign in to your account
and select the MIHA gallery.
(create an account if you have not done so already)**

dwf wedding photographer



MIHA State Finals 2011

Home > MIHA > MIHA State Meet 2011 > MIHA State Finals 2011

Gallery expires on December 31, 2011

Invite family & friends

Navigate galleries

8 Pages << Previous 1 2 3 4 5 6 7 8 Next >>



10-13 1845-Trail A



10-13 1845-Trail B



10-13 1850-Equitation over fences A



10-13 1850-Trail C



10-13 1850-Trail D



10-13 1855-Equitation over fences B



10-13 1855-Equitation over fences C



10-13 1855-Equitation over fences D



10-13 1855-Equitation over fences Ponies



10-13 1900-Western Riding A

3. Begin by selecting any category

Previous 1 2 3 4 5 6 7 8 Next >>

10-13 1850-Trail D

Home > MIHA > MIHA State Meet 2011 > MIHA State Finals 2011 > 10-13 1850-Trail D

Gallery expires on December 31, 2011

Invite family & friends

Navigate galleries

78 Images 1 2 3 4 Next >>



4. Select an image you want to add to your prepaid CD and click on it.

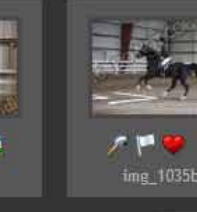
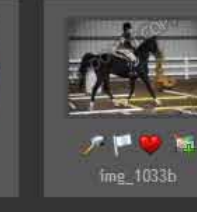
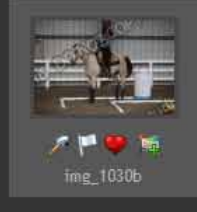
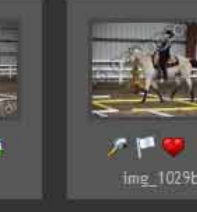
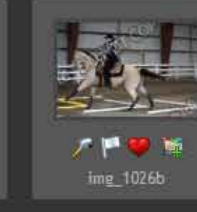
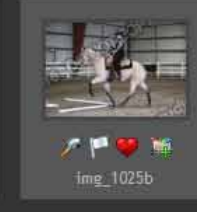
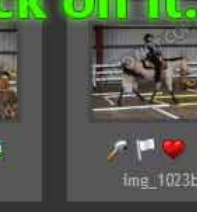
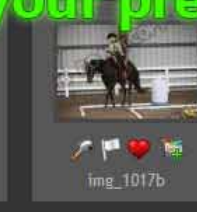
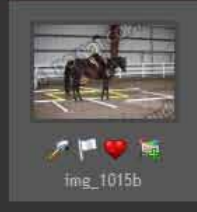

78 Images 1 2 3 4 Next >>

10-13 1850-Trail D

Home > MIHA > MIHA State Meet 2011 > MIHA State Finals 2011 > 10-13 1850-Trail D

Gallery expires on December 31, 2011

Invite family & friends

Navigate galleries



Thumbnails

Next >>



Image: img_1009b | Image ID: 413498

Image viewing disclaimer

Image gallery provided for informational purposes only. The image is a sample of the actual photo however, the final product will be made from the original high resolution file.

Please note that some cropping will occur with the different print sizes. You can see a sample of the crop when selecting a size, however it may not be cropped the same in final processing. Also black & white photos will be printed in black & white.

Add images to cart

| | |
|---------------------------|-------|
| Digital Single Image | \$5 |
| 4x6 | \$10 |
| 5x7 | \$15 |
| 8x10 | \$25 |
| 11x14 | \$35 |
| 16x20 Print | \$50 |
| 20x24 Gallery Wrap Canvas | \$175 |
| 16x20 Gallery Wrap Canvas | \$150 |
| 8 Wallets (same image) | \$15 |
| 48 Wallets (same image) | \$40 |

Packages & Collections

| | |
|-------------|-------|
| 10 Image CD | \$50 |
| 25 Image CD | \$100 |

Accessory Store

Have this picture on a variety of items in the accessory store. Memory Books, Specialty Items and More

5. You can click the image here again to see it even larger. To add the image to your CD select the CD image option to the right under "Packages and Collections"

10 Image CD

\$50



Choose 10 photos from this event and purchase using this option. All photos MUST BE from this event only. You cannot combine other galleries from other events on this CD. (example: If you are viewing the MIHA STATE MEET you may choose your images from the entire meet but not from any previous MIHA event) We will create your high resolution CD with limited copyright release and mail it to you.

10 Images

Add To Cart

Close this window



Image: img_1009b | Image ID:

Image viewing disclaimer

Images in galleries are scaled down for quicker viewing. Enlarging an image to view may not look as crisp as the actual photo however the final product will be made from the original high resolution file.

Please note that the photos are not cropped to the size you select when selecting a size, however it may not be cropped the same in final processing. All black & white and other previews may not represent the final product.

Accessories Store

Have this picture on a variety of items in the accessory store. Memory Book, Envelope, Item Book, Mug, etc.

6. The box above pops up. Select "Add To Cart"

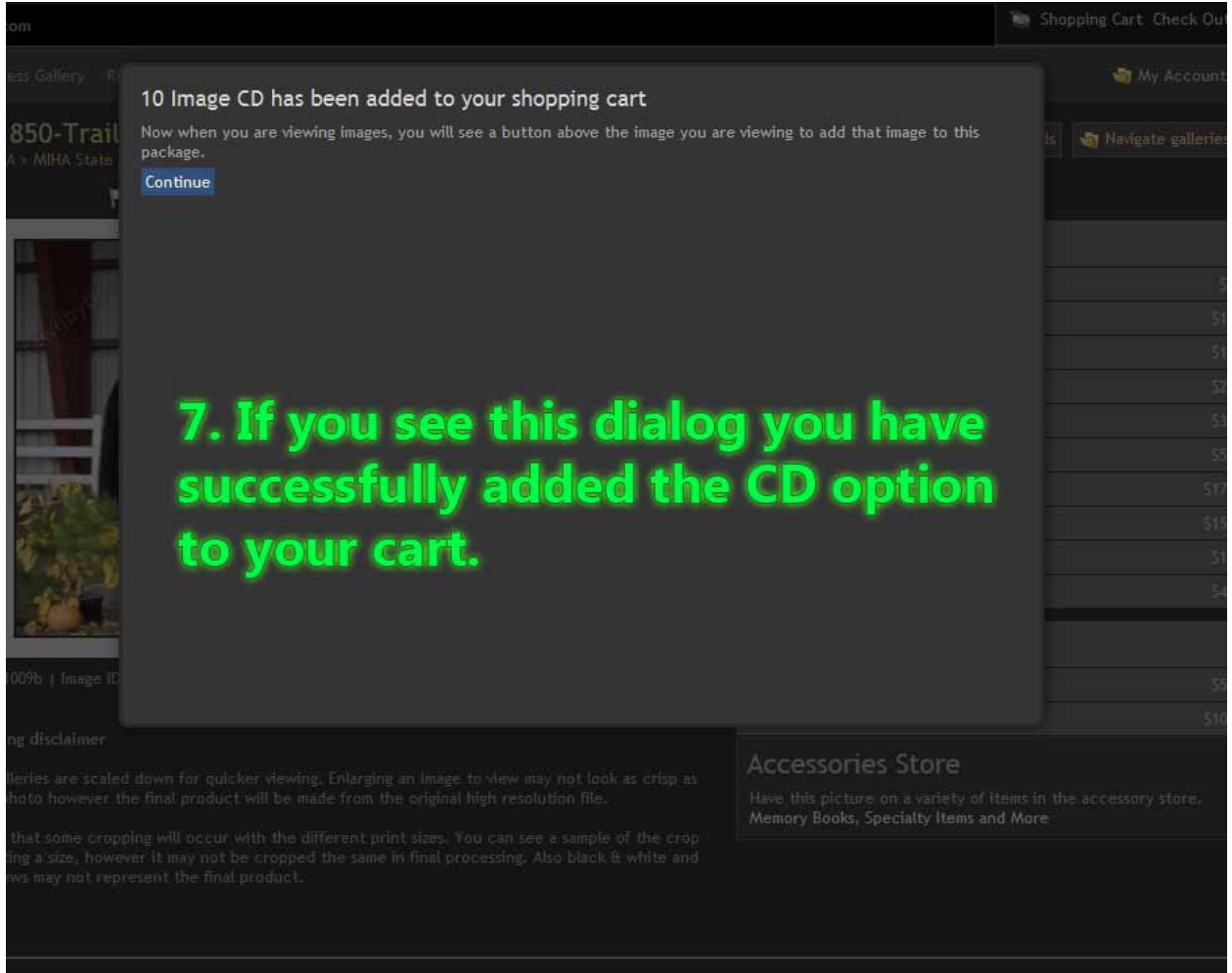

10 Image CD has been added to your shopping cart

Now when you are viewing images, you will see a button above the image you are viewing to add that image to this package.

[Continue](#)

7. If you see this dialog you have successfully added the CD option to your cart.

850-Trail
A > MIHA State



1009b | Image ID

ing disclaimer

alleries are scaled down for quicker viewing. Enlarging an image to view may not look as crisp as photo however the final product will be made from the original high resolution file.

that some cropping will occur with the different print sizes. You can see a sample of the cropping a size, however it may not be cropped the same in final processing. Also black & white and views may not represent the final product.

Shopping Cart Check Out

My Account

Navigate galleries

| |
|------|
| \$ |
| \$1 |
| \$1 |
| \$2 |
| \$3 |
| \$5 |
| \$17 |
| \$18 |
| \$1 |
| \$4 |
| \$5 |
| \$10 |

Accessories Store

Have this picture on a variety of items in the accessory store, Memory Books, Specialty Items and More

10-13 1850-Trail D

Home > MIHA > MIHA State Meet 2011 > MIHA State Finals 2011 > 10-13 1850-Trail D

Gallery expires on December 31, 2011

Invite family & friends

Navigate galleries

Thumbnails
Next >>
 Add this image to 10 Image CD



Image: img_1009b | Image ID: 413498

Image viewing disclaimer

Images in galleries are scaled down for quicker viewing. Enlarging an image to view may not look as crisp as the actual photo however the final product will be made from the original high resolution file.

Please note that some cropping will occur with the different print sizes. You can see a sample of the crop when selecting a size, however it may not be cropped the same in final processing. Also black & white and other previews may not represent the final product.

My Packages

Click on the package name(s) below to view the images you have selected.

10 Image CD

Options to cart

| | |
|---------------------------|-------|
| Digital Single Image | \$5 |
| 4x6 | \$10 |
| 5x7 | \$15 |
| 8x10 | \$25 |
| 11x14 | \$35 |
| 16x20 Print | \$50 |
| 20x24 Gallery Wrap Canvas | \$175 |
| 16x20 Gallery Wrap Canvas | \$150 |
| 8 Wallets (same image) | \$15 |
| 48 Wallets (same image) | \$40 |

Packages & Collections

| | |
|-------------|-------|
| 10 Image CD | \$50 |
| 25 Image CD | \$100 |

Accessories Store

Have this picture on a variety of items in the accessory store. Memory Books, Specialty Items and More

8. Click on the blue button above.

sbyte.com 550 Shopping Cart, Check Out

Access Gallery My Account

13 1850-Trail Navigate galleries

MIHA - MIHA State

10 Image CD Close this window

Add to package
cancel

You have selected 0 of 10 Images. Close this window

9. At this point you have not added any images to your package. Click on the blue "Add to Package" button.

img_1009b | Image ID

viewing disclaimer

es in galleries are scaled down for quicker viewing. Enlarging an image to view may not look as crisp as actual photo however the final product will be made from the original high resolution file.

se note that some cropping will occur with the different print sizes. You can see a sample of the crop n selecting a size, however it may not be cropped the same in final processing. Also black & white and y previews may not represent the final product.

| | |
|--|-------|
| 48 Wallets (same image) | \$40 |
| Packages & Collections | |
| 10 Image CD | \$50 |
| 25 Image CD | \$100 |
| Accessories Store | |
| Have this picture on a variety of items in the accessory store, Memory Books, Specialty Items and More | |

10-15 2145-Cloverleaf A

Home > MIHA > MIHA State Meet 2011 > MIHA State Meet 2011 > 10-15 2145-Cloverleaf A

Gallery expires on December 31, 2011

Invite family & friends

Navigate galleries

<< Previous Thumbnails Next >>

Add this image to 10 Image CD



Image: mba_3786e | Image ID: 428082

Image viewing disclaimer

Images in this gallery are shown in a smaller size than the original high resolution file. The actual size however, the final product will be made from the original high resolution file.

Please note that images shown with different print sizes. You can see a sample of the crop when selecting a size. Images are cropped at the same area. Other images in the gallery and other previews may not represent the final product.

10. Navigate to any other image in any other gallery. Select the image to add it to the CD by clicking on "Add this image to the 10 image cd" Button above the photo.

My Packages

Click on the package name(s) below to view the images you have selected.

10 Image CD

Add images to cart

| | |
|---------------------------|-------|
| Digital Single Image | \$5 |
| 4x6 | \$10 |
| 5x7 | \$15 |
| 8x10 | \$25 |
| 11x14 | \$35 |
| 16x20 Print | \$50 |
| 20x24 Gallery Wrap Canvas | \$175 |
| 16x20 Gallery Wrap Canvas | \$150 |
| 8 Wallets (same image) | \$15 |
| 10 Wallets (same image) | \$40 |

Packages & Collections

| | |
|-------------|-------|
| 10 Image CD | \$50 |
| 25 Image CD | \$100 |

Accessory Store

Have this picture on a variety of items in the accessory store. Memory Books, Specialty Items and More

com \$50 Shopping Cart Check Out

2145-Clov
HA - MIHA Stars
text A

My Account
Navigate galleries

10 Image CD

You have selected 1 of 10 Images.

img_1009b

remove

Close this window

Close this window

11. Again - "Add to package" .

Close this window

Close this window

| |
|-------|
| \$5 |
| \$10 |
| \$15 |
| \$20 |
| \$25 |
| \$30 |
| \$35 |
| \$40 |
| \$45 |
| \$50 |
| \$55 |
| \$60 |
| \$65 |
| \$70 |
| \$75 |
| \$80 |
| \$85 |
| \$90 |
| \$95 |
| \$100 |

40 Wallets (same image) \$40

Packages & Collections

| | |
|-------------|-------|
| 10 Image CD | \$50 |
| 25 Image CD | \$100 |

Accessories Store

Have this picture on a variety of items in the accessory store.
Memory Books, Specialty Items and More

Shopping Cart

[Redeem Coupon](#)[Return to the last image I viewed](#) [Return to the last gallery viewed 10-15 2145-Cloverleaf A](#)

Package

| Package | Price Each | Quantity | Extended |
|--|------------|--------------------------------|---|
| 10 Image CD | \$50 | <input type="text" value="1"/> | \$50 |
| You have selected 2 of 10 Pictures View selected images | | | Update Quantity remove |

Sub Total: \$50

[Empty Cart](#)[Check Out](#)

12. When you have selected all of your 10 or 25 images click on "Shopping Cart" at the top of the page. You will see "Redeem Coupon" in the top right. Enter your coupon code here.



Shopping Cart

Return to the last image

Package

| Package | Price Each |
|--|------------|
| 10 Image CD | \$50 |
| You have selected 2 of 10 Pictures View selected images | |

Redeem Coupon

If you have a coupon code, enter the code below and submit to continue.

Coupon:

Viewed 10-15 2145-Cloverleaf A

Extended \$50

Sub Total: \$50

13. Enter your coupon code here and submit.

dwf wedding photographer



Frawgbyte.com \$50 Shopping Cart Check Out

Home Access Gallery Redeem Print Credit Gift Certificates Help Search Registry Accessory Store My Account

Shopping Cart

Coupon has been added to your shopping cart.
Coupon MIHA 10 Image Prepaid CD 2011
Coupon expires on December 31, 2011
[Continue](#)

Redeem Coupon

| Package | Price Each | Extended |
|-------------|------------|----------|
| 10 Image CD | \$50 | \$50 |

You have selected 2 of 10 Pictures. [View selected images](#)

Sub Total: \$50

[Empty Cart](#) [Check Out](#)

14. You will see the confirmation above if your coupon code was accepted.
- Click on the blue "Check Out" button.

dwf wedding photographer

member dwf

VERIFIED Authorize.Net Click to SECURE

Check Out

Billing / Mailing Address

* Indicates a required field.

* First Name

* Last Name

* Email Address

* Re-type Email Address

* Phone Number

* Address

Address

* City

* Country

United States

* State

Michigan

* Postal Code

Continue

Checkout Progress

- 1 Billing / Mailing Address
- 2 Shipping / Delivery Method
- 3 Review
- 4 pay

Billing / Mailing Address

15. enter your billing / mailing address and select the blue "continue" button.

dwf wedding photographer



Check Out

Shipping Options

Please select from below

- Standard Shipping (\$4.00*)
- Free Digital Download (\$0.00*)
select for free download images.
- Priority Mail (\$10.00*)
- Deliver to Edgewood (\$2.00*)
For Edgewood Country Club Members Only - We can deliver your order to Edgewood.
- CD Only (\$4.00*)
Select this option if ordering just CD's or DVD's
- Prepaid Orders Only (\$0.00*)
Select this option if you need a prepaid order
- email (\$0.00*)
email image

Estimated based on current location. May change on next page display

Checkout Progress

- 1 Billing / Mailing Address
- 2 Shipping / Delivery Method
- 3 Review
- 4 pay

Billing / Mailing Address

██████████
██████████
██████████
██████████

16. Select Prepaid orders for shipping

Shipping

* Indicates a required field.

| | |
|------------|-----------------|
| * Name | * Phone Number |
| ██████████ | ██████████ |
| * Address | Address |
| ██████████ | ██████████ |
| * City | * Country |
| ██████████ | United States ▼ |
| * State | * Postal Code |
| Michigan ▼ | ██████████ |

Continue

Check Out

If you are ready to check out, confirm the information below. This will create an invoice for you also.

Order Calculation

| | |
|---------------------------------------|---------|
| Total: | \$50.00 |
| Discount - Coupon: (miha10) (\$50.00) | |
| Prepaid Orders Only: | \$0.00 |
| Tax (6% on \$0.00) | \$0.00 |
| Grand Total: | \$0.00 |

How do you plan to pay

Pay By Credit Card

Select this option if you are paying by Credit Card

Mail a check

Select this option if you are paying by check. Please note that your order will not be placed until your check has cleared our bank.

Pre-Paid Order

Select only if your order has been prepaid. (At checkout you will still see a total. Disregard the amount due.)

Pre-Order Digital Image

Select this option if you pre-ordered a digital image. We will email the digital image to you. (At checkout you will still see a total. Disregard the amount due.)

Edgewood Member Number

EW: We can now accept your Edgewood Member number as payment for your order. We will automatically charge to the Edgewood Member number. Please include your member number in the comment field.

Special notes or comments for this order

Please enter any text required for your order.

[Place this order](#)

Checkout Progress

- 1 Billing / Mailing Address
- 2 Shipping / Delivery Method
- 3 Review
- 4 pay

Billing / Mailing Address

██████████
██████████
██████████
██████████

██████████
██████████
██████████
██████████

██████████
██████████
██████████
██████████

[Click here to edit your shopping cart.](#)

Coupon

Coupon [miha10] \$50.00 - Coupon expires on December 31, 2011

[remove](#)

Total discount will be calculated on your final checkout screen.

Package

| | Price Each | Quantity | Extended |
|-------------|------------|--------------------------------|----------|
| 10 Image CD | \$50.00 | <input type="text" value="1"/> | \$50.00 |

You have selected 2 of 10 Pictures:
[View selected images](#)

Sub Total: \$50.00

17. Select "Pre-Paid Order" for Payment type and then click the blue "Place this Order" button below.

Order #10929

October 24, 2011

| | |
|-----------------|-------|
| Total | 50.00 |
| Status | New |
| Prints / Images | 2 / 2 |

Customer

Shipping Information [Prepaid Orders Only]

Plan to pay: Pre-Paid Order

Package

| 10 Image CD | Price Each | Quantity | Extended |
|---|------------|--|----------|
| Choose 10 photos from this event and purchase using this option. All photos MUST BE from this event only. You cannot combine other galleries from other events on this CD. (example: If you are viewing the MIHA STATE MEET you may choose your images from the entire meet but not from any previous MIHA event) We will create your high resolution CD with limited copyright release and mail it to you. | \$50.00 | 1 | \$50.00 |
| 1: Image img_1009b [ID: 413498]  MIHA > MIHA State Meet 2011 > MIHA State Finals 2011 > 10-13 1850-Trail D | | 1: Image mha_3786e [ID: 428082]  MIHA > MIHA State Meet 2011 > MIHA State Finals 2011 > 10-15 2145-Cloverleaf A | |

| | |
|-----------|-----------|
| Sub Total | \$50.00 |
| Coupon | (\$50.00) |
| Total | \$0.00 |

18. Congratulations! Your order has been placed!
We will check your prepaid account against our list and prepare your CD for mailing. If you would like to upgrade your 10 image CD to a 25 image CD at the show special please contact us at photos@frawgbyte.com with the subject "CD Upgrade" .

